



Durable, Rigid, Click-Fit Luxury Vinyl | By Verona



Welcome
to the future of flooring

Rodellar Stone Silver



Durable, Rigid, Click-Fit Luxury Vinyl | By Verona

ClickLux combines next generation technology with the latest design trends to offer a stylish and versatile collection of rigid SPC flooring that's suitable for a wide range of projects.

You will find everything you need to know about ClickLux on the following pages, from design inspiration to technical specifications and installation advice.

Welcome to the future of flooring.



Weathered Ash



Axia Concrete Anthracite

Contents

4. What is ClickLux?

Planks

- 6. Silver Birch
- 7. Black Elm
- 8. Weathered Ash
- 9. Limed Oak
- 10. Light Oak
- 11. Warm Maple
- 12. Antique Cedar
- 13. Rustic Willow
- 14. Golden Beech
- 15. Rich Walnut

Tiles

- 16. Axia Concrete Anthracite
- 17. Axia Concrete Grey
- 18. Chamonix Marble Beige
- 19. Castello Marble White
- 20. Bowfell Stone Grey
- 21. Rodellar Stone Silver
- 22. Pinnacle Concrete Anthracite
- 23. Pinnacle Concrete Grey

- 24. Installation guide
- 26. Aftercare
- 27. Index

What is ClickLux?



Waterproof



Easy to Install



Dust Free



Warm Underfoot



Anti-Bacterial



Sound Insulation



Low Maintenance



Eco-Friendly



PHTHALATE Free



Integrated Underlay

ClickLux is a collection of premium SPC planks & tiles reminiscent of natural wood and stone but with several added benefits. The wood effects come in an elongated 177.8 x 1219.2mm plank size, whilst the tile-style designs come in a classic 305 x 610mm size.

Manufactured using state of the art technology, SPC (Stone Polymer Composite) is the next generation of Luxury Vinyl Tiles, combining limestone and stabilisers to create a very durable core. SPC is hardwearing, waterproof and more rigid than traditional LVT, making it suitable for domestic and commercial projects.

It features an easy to install locking system without the need for messy adhesives and you don't even have to worry about purchasing separate underlay as there's a 1mm foam underlay already built in to each plank, making any room instantly warm and cosy and speeding up the installation process. For added warmth the ClickLux collection can also be used with piped water underfloor heating up to 29°C.

ClickLux comes with a 20 year warranty for domestic use and 5 year warranty for commercial use, so you can be confident your new flooring will look good for years to come.



Bowfell Stone Grey



Rustic Willow

Next Generation SPC Layers

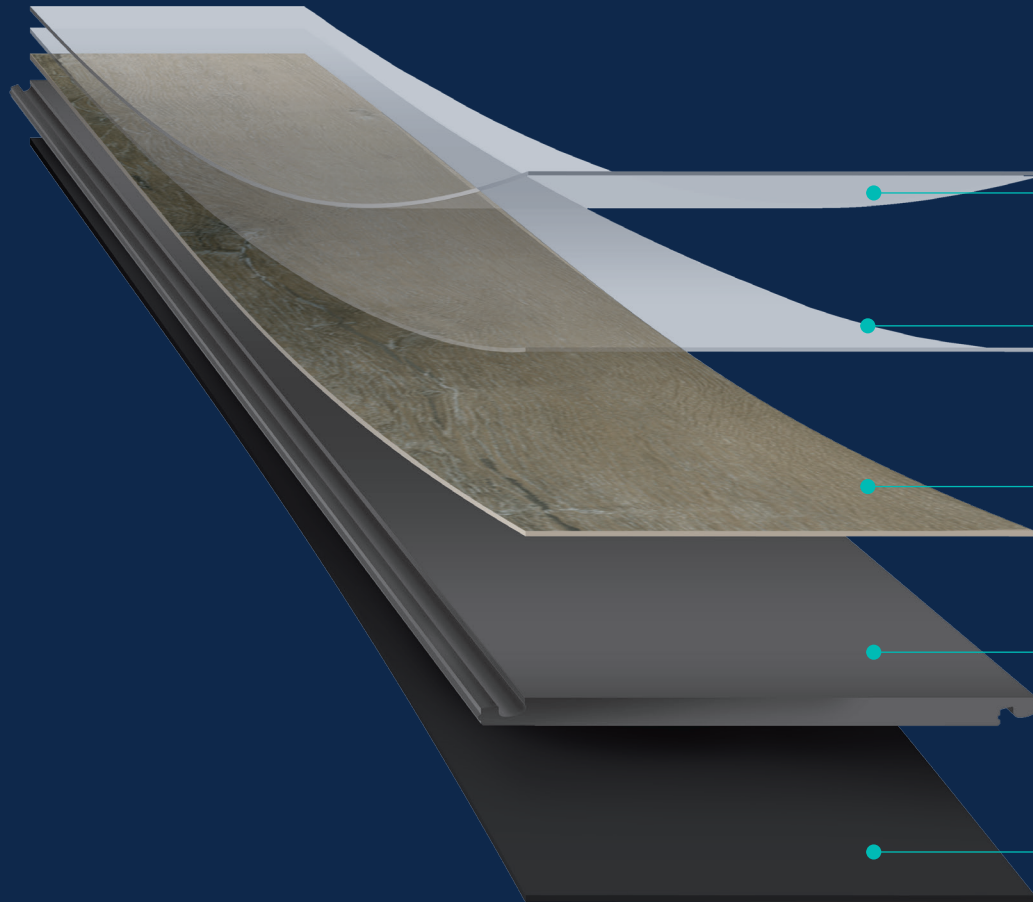

UV LAYER

Protects against sun damage

WEAR LAYER

Protects against spills and scratches and gives a realistic texture

COLOUR FILMS

Printed in high definition to give a realistic and authentic look

SPC CORE

The Stone Polymer Composite core is durable, waterproof and rigid and has click-fit edging for easy installation

UNDERLAY

Integrated 1mm IXPE foam provides heat and sound insulation

Silver Birch

The soft grey shade and simple design of Silver Birch will complement a wide range of rooms, whilst the click-fit system and integrated underlay makes installation child's play.

The hygienic and dust-free finish is ideal for bedrooms

Size | 177.8 x 1219.2mm
Pack quantity | 10
Pack coverage | 2.167m²
Wear layer | 0.3mm
Code | L10007





Black Elm

This striking dark wood grain finish will create a sophisticated feel in any room, whilst also being waterproof and durable.

Size | 177.8 x 1219.2mm
Pack quantity | 10
Pack coverage | 2.167m²
Wear layer | 0.3mm
Code | L10002

Weathered Ash

Bridging the gap between cool grey and warmer natural wood shades, Weathered Ash will complement a variety of interior colour schemes.

Size | 177.8 x 1219.2mm
Pack quantity | 10
Pack coverage | 2.167m²
Wear layer | 0.3mm
Code | L10003



Also featuring Handmade White 75x300mm wall tiles. Visit www.veronagroup.co.uk for more details.



Limed Oak

The palest of all the ClickLux designs, Limed Oak has a soft neutral feel that will bring a sense of light and calm to any room.

Durable and
waterproof -
perfect for busy
bathrooms

Also featuring Brecon White 250x500mm wall tiles. Visit www.veronagroup.co.uk for more details.

Size | 177.8 x 1219.2mm
Pack quantity | 10
Pack coverage | 2.167m²
Wear layer | 0.3mm
Code | L10010

Light Oak

This classic Light Oak shade is contemporary yet timeless. Use throughout the home as a durable alternative to natural wood flooring that's warm underfoot.



Size | 177.8 x 1219.2mm
Pack quantity | 10
Pack coverage | 2.167m²
Wear layer | 0.3mm
Code | L10005



Warm Maple

Featuring very subtle cross-cut saw marks, Warm Maple gives the look and feel of real wood but in a waterproof finish that's ideal for bathrooms.

Combine
SPC flooring
with ceramic or
porcelain wall
tiles

Also featuring Kynance White 250x500mm wall tiles. Visit www.veronagroup.co.uk for more details.

Size | 177.8 x 1219.2mm
Pack quantity | 10
Pack coverage | 2.167m²
Wear layer | 0.3mm
Code | L10008

Antique Cedar

This traditional timber effect design features subtle knot and wood grain details. It's ideal for creating seamless flooring from one room to the next throughout the home.

Size | 177.8 x 1219.2mm
Pack quantity | 10
Pack coverage | 2.167m²
Wear layer | 0.3mm
Code | L10009



Also featuring Kynance White 250x500mm wall tiles. Visit www.veronagroup.co.uk for more details.



Rustic Willow

Perfect for period properties, this is the most rustic of the ClickLux designs. It offers realistic shading variations, wood grain details and a lightly distressed appearance, but unlike real wood it's completely waterproof.

Size | 177.8 x 1219.2mm
Pack quantity | 10
Pack coverage | 2.167m²
Wear layer | 0.3mm
Code | L10006

Golden Beech

Featuring a Golden Beech colour with subtle shade variations and wood grain detailing, this design will give any room a warm and cosy feel.

Give dining areas a spill-proof finish that's easy to clean

Size | 177.8 x 1219.2mm
Pack quantity | 10
Pack coverage | 2.167m²
Wear layer | 0.3mm
Code | L10001





Rich Walnut

Deep and sophisticated, Rich Walnut is a timeless classic. Its low maintenance and sound insulating properties make it the perfect choice for busy areas such as hallways.

Size | 177.8 x 1219.2mm
Pack quantity | 10
Pack coverage | 2.167m²
Wear layer | 0.3mm
Code | L10004

Axia Concrete Anthracite

Perfect for modern interiors, Axia features subtle flecks of terrazzo stone-like pieces that give a nod to the industrial trend in a tonal Anthracite shade.

Size | 305 x 610mm
Pack quantity | 10
Pack coverage | 1.86m²
Wear layer | 0.56mm
Code | L10017



Also featuring Central White 100x200mm wall tiles. Visit www.veronagroup.co.uk for more details.



Axia Concrete Grey

Create a lived in feel with the weathered concrete effect of Axia Concrete Grey in a durable and hard wearing finish that's perfect for entrances and hallways.

The easy to clean surface is great for a busy family hallway

Size | 305 x 610mm
Pack quantity | 10
Pack coverage | 1.86m²
Wear layer | 0.56mm
Code | L10016

Chamonix Marble Beige

Create a cosy ambience in any room with the warming shade of Chamonix Marble Beige. Coordinate with natural textures for a rustic feel that's easy to maintain.

Size | 305 x 610mm
Pack quantity | 10
Pack coverage | 1.86m²
Wear layer | 0.56mm
Code | L10018



Also featuring Coffee Stone Hexagon Mosaic 300x300mm wall tiles. Visit www.veronagroup.co.uk for more details.



Castello Marble White

Perfect for modern spaces, Castello Marble White offers a sleek and contemporary look with realistic veining detail. Unlike real marble, it doesn't require sealing and will look immaculate for years to come.

Stylish
and versatile,
easily give your
floors an on-
trend look

Also featuring Handmade White 75x150mm wall tiles. Visit www.veronagroup.co.uk for more details.

Size | 305 x 610mm
Pack quantity | 10
Pack coverage | 1.86m²
Wear layer | 0.56mm
Code | L10013

Bowfell Stone Grey

Contemporary and sophisticated, Bowfell Stone Grey is a timeless classic. Extend the design seamlessly throughout the home for a flawless look that's also warm underfoot.

Size | 305 x 610mm
Pack quantity | 10
Pack coverage | 1.86m²
Wear layer | 0.56mm
Code | L10021





Also featuring Pueblo Silver 300x900mm wall tiles. Visit www.veronagroup.co.uk for more details.

Rodellar Stone Silver

The warm silver shade and natural stone design of Rodellar will complement a variety of rooms throughout the home, whilst the click-fit system makes installation a breeze.

Size | 305 x 610mm
Pack quantity | 10
Pack coverage | 1.86m²
Wear layer | 0.56mm
Code | L10024

Pinnacle Concrete Anthracite

The striking deep Anthracite shade and weathered concrete effect finish will create a modern feel in any room, whilst also being splash-proof and practical.

Size | 305 x 610mm
Pack quantity | 10
Pack coverage | 1.86m²
Wear layer | 0.56mm
Code | L10015



Also featuring Hope White 75x300mm wall tiles. Visit www.veronagroup.co.uk for more details.



Also featuring Loft White 300x600mm wall tiles. Visit www.veronagroup.co.uk for more details.

Pinnacle Concrete Grey

Featuring a distressed textured pattern with subtle tonal shading, Pinnacle Concrete Grey gives the look of a raw natural material but in a waterproof finish that's perfect for bathrooms.

Size | 305 x 610mm
Pack quantity | 10
Pack coverage | 1.86m²
Wear layer | 0.56mm
Code | L10014

You will need:



Tape Measure



Utility Knife



T-Square



6mm Spacer Wedges



Rubber Mallet



Tapping Block



Pencil



Pull Bar



Skirting Boards

You may also need:



Hole Saw



PVA Glue



Silicone Caulk

How much ClickLux do I need?

Follow these simple steps to calculate how many packs of ClickLux you will need for your project.

1. Measure the length and width of the room in metres and multiply the two values together. This will give you the square metre coverage. For irregular shaped rooms, try breaking the area into smaller rectangles. Calculate the area of each rectangle then add the values together.
2. We recommend adding an additional 10% to the total area to allow for cuts and wastage during the installation process. To calculate this, multiply the total square metre coverage by 1.1.
3. Each box of 10 ClickLux planks totals 2.167 square metres. Each box of 10 ClickLux tiles totals 1.86 square metres. Divide your total from step 2 by 2.167 for planks or 1.86 for tiles to calculate how many boxes of ClickLux you will need. Always round this number up.

Installation Guide

Before installing ClickLux, acclimatise the pieces to room temperature. We recommend placing the boxed product flat on the floor in the desired room 48 hours prior to installation at a temperature between 18 - 30°C. Do not place the boxes directly onto concrete flooring. If you have a concrete floor you must raise the boxes up slightly away from this. Always lay boxes flat to avoid damage to the locking profiles.

ClickLux should be installed in accordance with British Standard BS 8203:2017. Before you begin, ensure that the sub-floor is dry, clean, smooth, level and free from dust and debris. Sweep and/or vacuum the area and remove all obstructions such as furniture, doorplates and skirting boards where possible. If you are installing ClickLux in a kitchen or bathroom, ensure any fixed cabinets have already been installed as ClickLux cannot be installed underneath these.

To ensure your ClickLux floor looks its best, select boxes with the same batch and production date and mix pieces from multiple packages to achieve a natural shading blend. Be sure to inspect each piece for colour, shade, surface texture and possible damages prior to fixing. Do not install pieces with damages or defects.

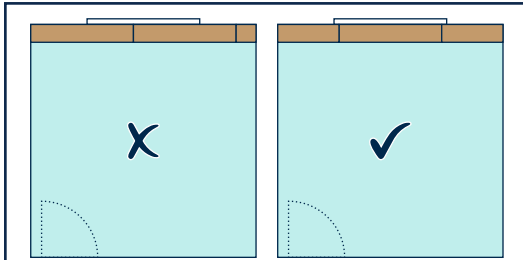

1. Lay your first row of ClickLux planks or tiles out next to one another to determine the best fit. To achieve an even look, you may need to cut the first piece to a shorter length. It is advisable to set out your pieces so that the cuts lengths at each end are more than 20cm in length.

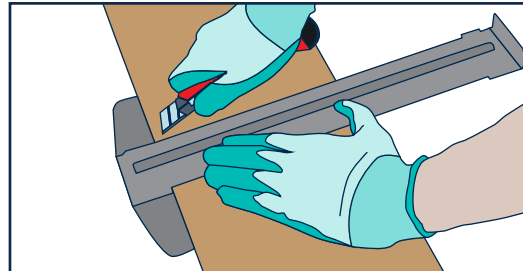

2. To cut your ClickLux to size, measure and mark with a pencil. Using a T-square and utility knife, apply pressure and score along the line. Gently flex along the scored edge until it separates into two pieces.

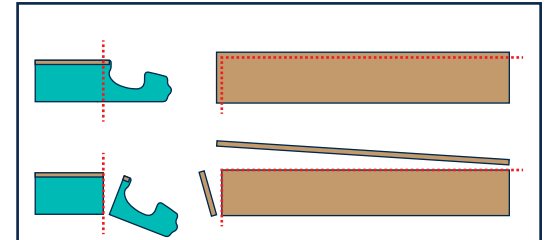

3. To achieve a perfect fit, always fit a cut edge next to walls rather than a locking profile. For pieces that sit in the corner of a room, this will mean cutting both the long and short edges to remove the locking profile.

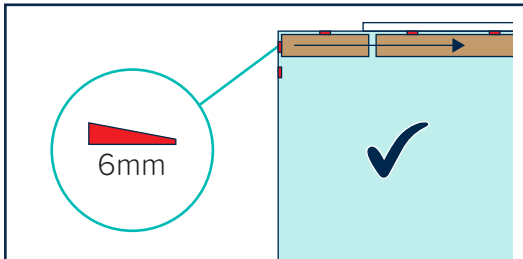

4. Begin installing ClickLux from the left side of your room and always work to the right. Use spacer wedges next to any piece that meets a wall to ensure a 6mm expansion gap is left around the perimeter.

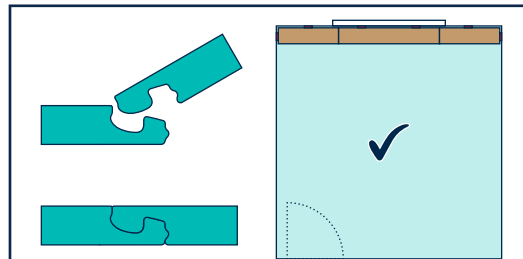

5. To install the first row, insert the tongue side into the groove side of the previous piece at an angle of around 30°. Gently apply inwards and downwards pressure until the joint closes and the pieces lay flat. Continue to install further pieces until the first row is complete.

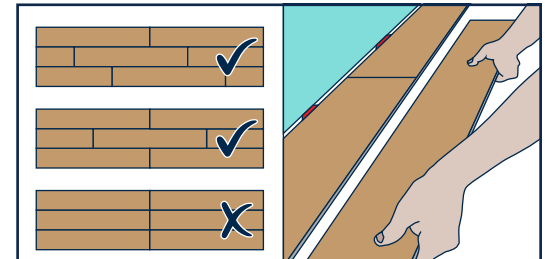

6. When starting a new row, always remember to work from left to right. Pieces can be easily locked together on the long edge by angling the joint and applying pressure in the same way as the short edge. Always ensure the joints are staggered by at least a third.

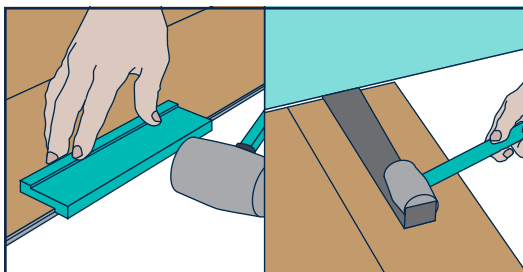

7. Continue to lay pieces along the second row by locking the long sides to the previous row. The short edges should drop on top of the previous plank and click into place. Use a rubber mallet and a tapping block to make sure all joints are locked flush to one another. Use a pull bar at the end of a row.

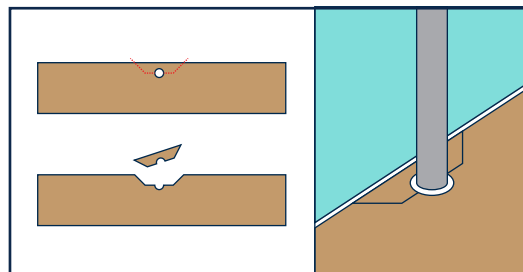

8. ClickLux can be easily fit around pipes by using a hole saw. Use a utility knife and cut a few centimeters away from the hole horizontally then at a 45° angle to the edge. Always leave a 6mm expansion gap around all pipes and objects. Reattach the pieces together using PVA glue.

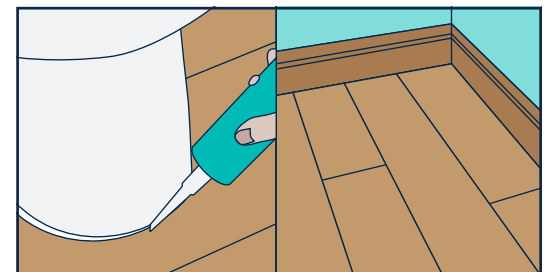

9. Continue to work left to right row by row. Once the floor is complete, remove the spacer wedges. Finish the look with skirting boards around the perimeter to conceal the expansion gaps. For splash areas such as bathrooms, high quality silicone caulking should be used to prevent water seepage.

Aftercare

ClickLux SPC flooring is easy to maintain. Simply remove dust and loose debris by sweeping with a soft brush or vacuuming using a nozzle suitable for vinyl floors.

Although the product is waterproof, we recommend that you mop up any spills straight away. Any stains can be removed using a well wrung out mop or damp cloth with warm water and a suitable vinyl floor cleaner, making sure to rinse and dry the floor.

Never use abrasive scourers or incorrect acidic or alkaline cleaners that are not suitable for vinyl floors.

Protect your floors by installing doormats at the entrances to your home. Metal abrasion can scratch or discolour your flooring. Chairs and furniture should be fitted with protective furniture pads.



Index



Antique Cedar
Page 12



Axia Concrete Anthracite
Page 16



Axia Concrete Grey
Page 17



Black Elm
Page 7



Bowfell Stone Grey
Page 20



Castello Marble White
Page 19



Chamonix Marble Beige
Page 18



Golden Beech
Page 14



Light Oak
Page 10



Limed Oak
Page 9



Pinnacle Concrete Anthracite
Page 22



Pinnacle Concrete Grey
Page 23



Rich Walnut
Page 15



Rodellar Stone Silver
Page 21



Rustic Willow
Page 13



Silver Birch
Page 6



Warm Maple
Page 11



Weathered Ash
Page 8



Please note that product images are shown for indicative purposes only and colour reproduction throughout this catalogue is as accurate as printing techniques allow. We recommend you visit your local retailer to view a sample of the product before purchasing. Please contact us to find your nearest retailer. Although we endeavour to communicate any changes as soon as possible, we reserve the right to amend or withdraw products contained within this catalogue at any time without prior notice. As variations in colour, shading and texture may occur between different batches of SPC, we recommend you purchase sufficient packs in one go to complete a project. Please ensure a satisfactory blend of shades can be achieved BEFORE fixing as claims relating to variations that were apparent before fixing will not be accepted once the product has been installed.

Please refer to our Terms & Conditions of Sale for further details.

www.clicklux.co.uk

Verona, Project House, Armley Road, Leeds, LS12 2DR | 0113 244 4984 | www.veronagroup.co.uk | sales@veronagroup.co.uk

M10289 September 2021 v1